



# INSTALLATION INSTRUCTIONS



## PINCH TAB FRONT WIPER BLADE



To remove the current wiper blade pinch the tabs on both sides of the connector and rotate the wiper away from the arm.



Next, remove the new Ezywiper blade from its packaging.  
To fit the Ezywiper blade, insert the tab (see inset) at the top of the wiper's adaptor into the arm.



Rotate the blade while pinching the side tabs until the blade locks into place (see inset).  
Check the blade is securely fitted.

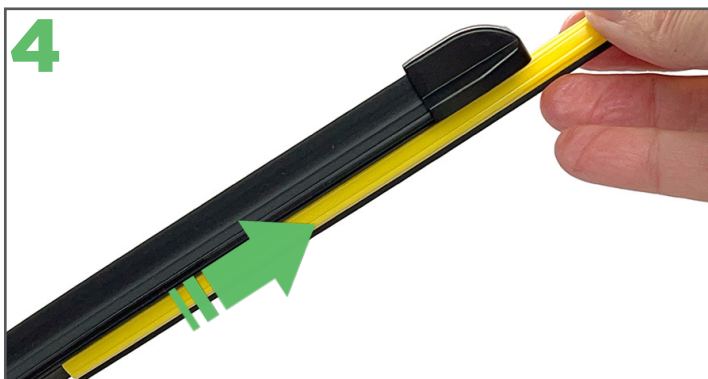

Remove the protective sleeve from the Ezywiper blade then place the arm back on the windscreen.



Check the low spoiler side of the blade faces the bottom of your windscreen.

For installation videos and more info see [ezywiper.co.nz](http://ezywiper.co.nz)