



INSTALLATION INSTRUCTIONS



CROSS PIN REAR WIPER BLADE

STEP 1: PREPARE THE EZYWIPER BLADE

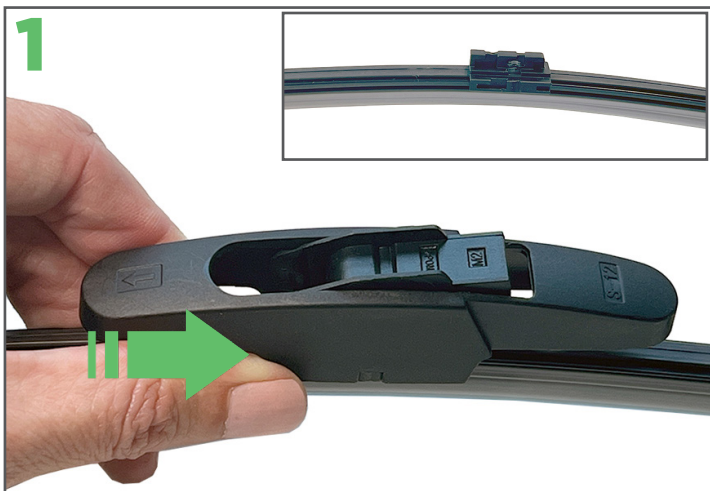

Remove the new Ezywiper blade from its packaging. Your car's wiper arm needs a different adaptor than the one on the Ezywiper blade. To remove the adaptor, locate the arrow at the top of the adaptor, then gently push in the opposite direction until the adaptor disengages (see the inset for what the wiper looks like once the adaptor is removed).

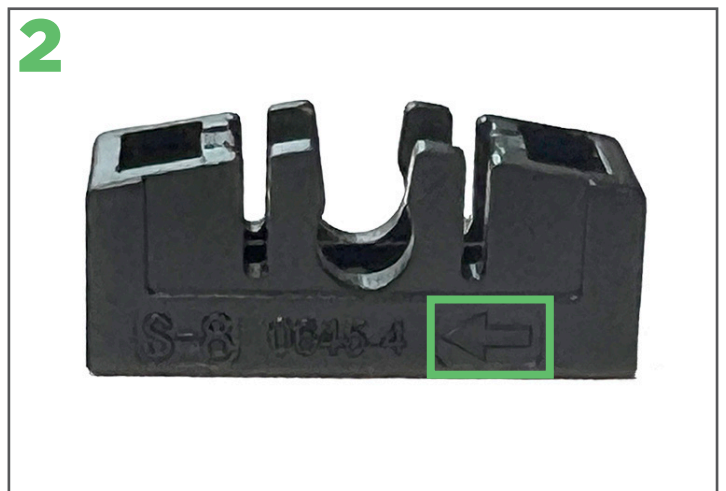

Next, select the S-8 adaptor from the bag of adaptors supplied with the blade. Locate the arrow on the side of the adaptor.

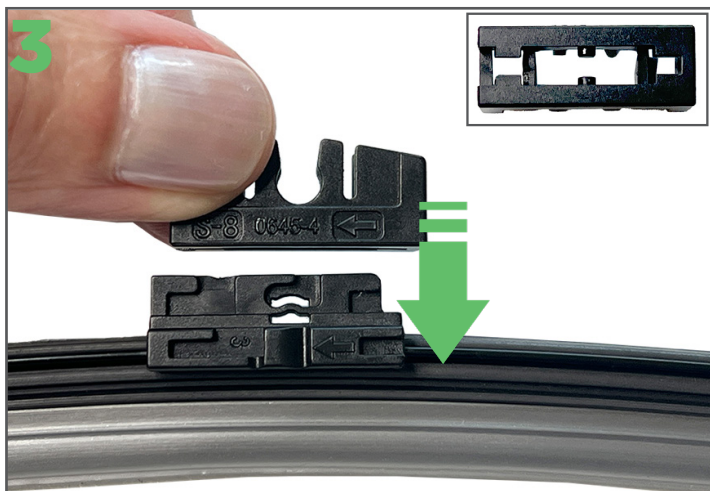

The bottom of the adaptor has a slot that fits over the mount on the blade (see inset). Check the arrows on the blade mount and adaptor are pointing in the same direction. Gently fit the adaptor onto the mount.

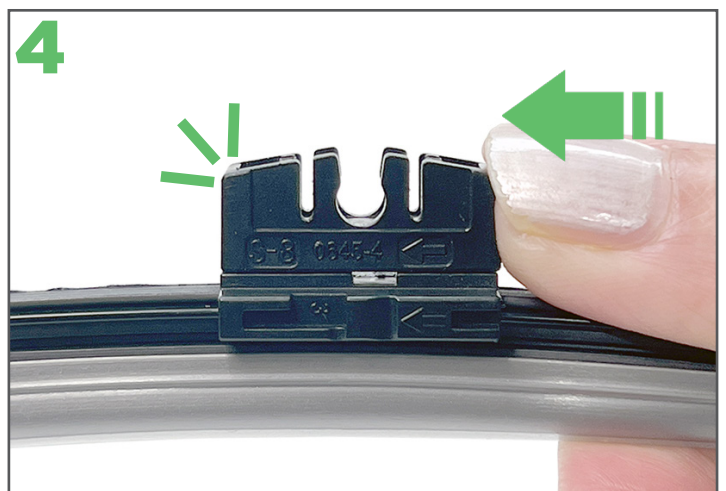

Slide the adaptor in the direction of its arrow until the adaptor clicks into place.

STEP 2: FIT THE EZYWIPER BLADE

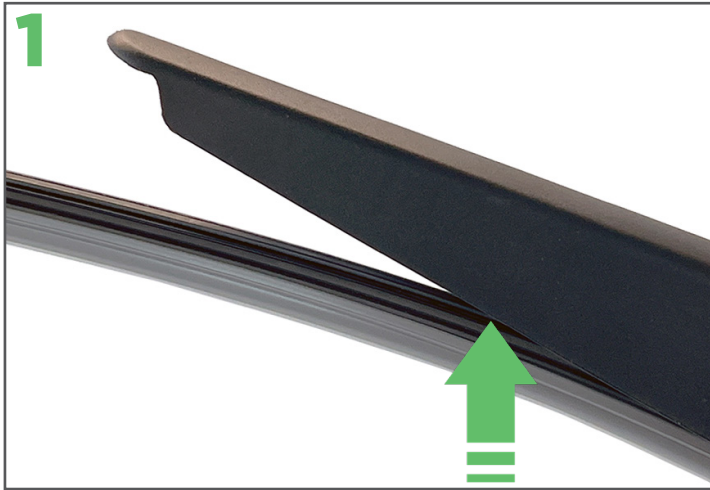

Lift the car's rear wiper arm off the rear screen as far as it will go.



To remove the current wiper blade gently rotate the blade away from the arm until it disengages.



To fit the new Ezywiper blade, align the blade with the arm. The arrows on the mount and adaptor point to the front of the arm.



Gently push the Ezywiper blade onto the arm until it locks into place.



Don't forget to remove the protective sleeve from the Ezywiper blade before placing the arm back on the rear screen.



For installation videos and more info see ezywiper.co.nz